

SIMONSWERK

BAKA®

butt hinge QR 100

for unrebated timber door leaves

hinge

Technical details

knuckle length	70,0 mm
overall length	100,0 mm
h x b frame leaf	100,0 x 26,5 mm
material thickness	2,35 mm
screws	5,0 x 50,0 mm
h x b door leaf	100,0 x 26,5 mm
pin diameter	10,0 mm

Note

Version with fixed pin and central straps.

Als available as maintenance-free QR 100 WF ER made of solid stainless steel.
Please consider DIN reference.

installation tools

universal milling frame
template 5 250582 5

Items (DIN reference: DIN left hand)

Finish(es)	galvanised
packing unit	pack of 10
item number	5 130643 2 01006
Finish(es)	nickelled
packing unit	pack of 10
item number	5 130643 2 01506

Items (DIN reference: DIN right hand)

Finish(es)	galvanised
packing unit	pack of 10
item number	5 130643 1 01006
Finish(es)	nickelled
packing unit	pack of 10
item number	5 130643 1 01506

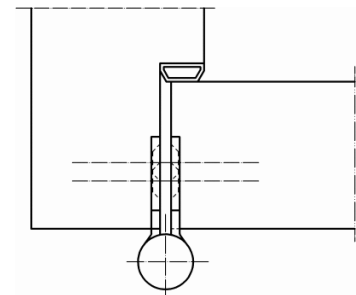
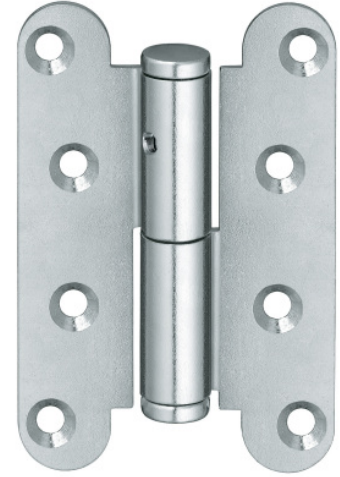

cross section