

# SIMONSWERK

## METAL CONSTRUCTIONS

### KO 50 180

2-part weld-on hinge with flat tip and steel pin

#### hinge

#### Technical details

knuckle length	180,0 mm
knuckle diameter	20,0 mm
material thickness	5,0 mm
pin diameter	13,0 mm

#### Note

Version with steel pin and brass raceway.

**Items** (DIN reference: DIN right and left hand)

<b>Finish(es)</b>	steel self colour
<b>packing unit</b>	pack of 25
<b>item number</b>	5 180748 0 00208

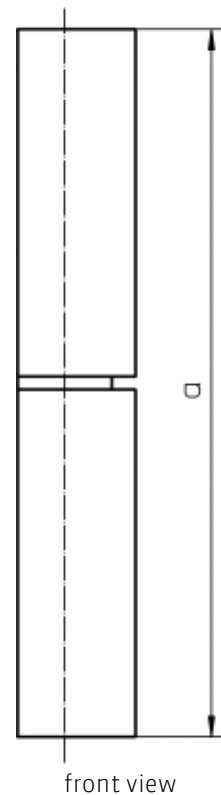

# SIMONSWERK

## METAL CONSTRUCTIONS

### KO 50 180

2-part weld-on hinge with flat tip and steel pin

hinge

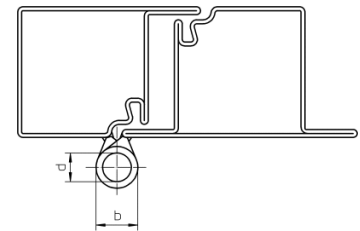

cross section