

# SIMONSWERK

## METAL CONSTRUCTIONS

### KO 50 60

2-part weld-on hinge with flat tip and steel pin

#### hinge

#### Technical details

knuckle length	60,0 mm
knuckle diameter	10,0 mm
material thickness	2,25 mm
pin diameter	5,5 mm

#### Note

Version with steel pin and brass raceway.

**Items** (DIN reference: DIN right and left hand)

<b>Finish(es)</b>	steel self colour
<b>packing unit</b>	pack of 25
<b>item number</b>	5 180742 0 00208

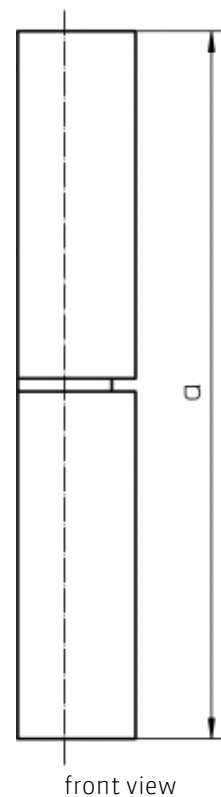

front view

# SIMONSWERK

## METAL CONSTRUCTIONS

### KO 50 60

2-part weld-on hinge with flat tip and steel pin

hinge

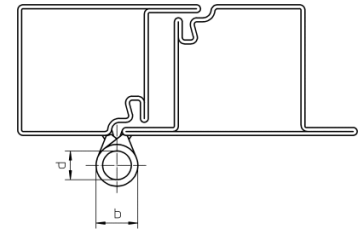

cross section