

# SIMONSWERK

## METAL CONSTRUCTIONS

### KO 50 ER 100

2-part weld-on hinge made from stainless steel with round tip and stainless steel pin

#### hinge

#### Technical details

knuckle length	100,0 mm
knuckle diameter	16,0 mm
material thickness	3,0 mm
pin diameter	10,0 mm

#### Note

Stainless steel version with stainless steel pin and stainless steel raceway.

**Items** (DIN reference: DIN right and left hand)

<b>Finish(es)</b>	satin brushed stainless steel
<b>packing unit</b>	pack of 20
<b>item number</b>	5 180744 0 04007

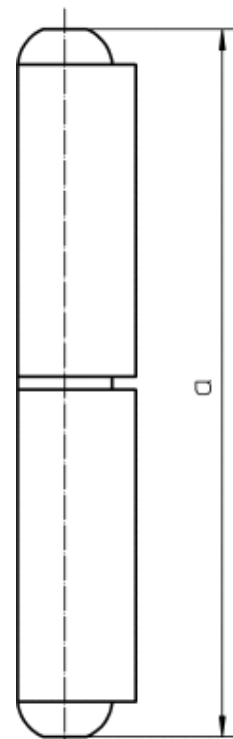

front view

# SIMONSWERK

## METAL CONSTRUCTIONS

### KO 50 ER 100

2-part weld-on hinge made from stainless steel with round tip and stainless steel pin

hinge

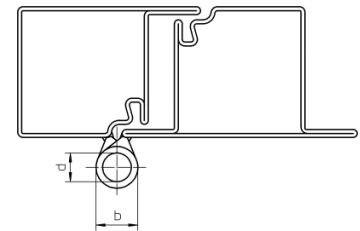

cross section