

# SIMONSWERK

## BAKA®

### gate hinge T 9/220

for unrebated timber gates

#### hinge

#### Technical details

knuckle length	220,0 mm
h x b frame leaf	70,0 x 50,0 mm
material thickness	4,0 mm
screws	6,0 x 50,0 mm
h x b door leaf	80,0 x 50,0 mm
pin diameter	14,0 mm

#### Note

Version with loose, galvanised pin.

Use of washers or ball bearings obligatory. These are not included in the delivery.

#### Combination

accessories	iron washer 14 mm
	steel washer 14 mm
	brass washer 14 mm
	ball bearing 14 mm

**Items** (DIN reference: DIN right and left hand)

<b>Finish(es)</b>	galvanised
<b>packing unit</b>	pack of 6
<b>item number</b>	5 130656 0 01005

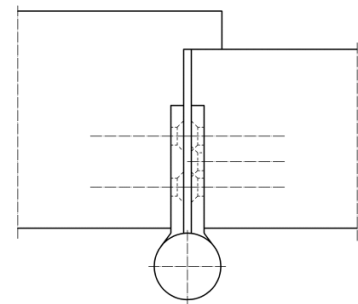
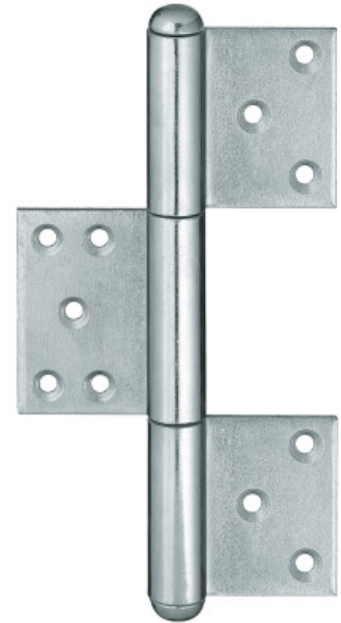

cross section